

**ITEM 7. MOBILE CRANE – TEMPORARY ROAD CLOSURES – FRANCIS
STREET GLEBE**

TRIM RECORD NO: 2016/059244

RECOMMENDATION

It is recommended that the Committee endorse the temporary road closure of Francis Street, between Glebe Point Road and Bay Street, Glebe, on Monday 4 April 2016 and Tuesday 5 April 2016 from 9pm to 5am, subject to the following conditions:

- (A) The Applicant must comply with the temporary road closure conditions as mentioned in Schedule C of this Agenda.
- (B) The Applicant must comply with any other conditions imposed by City's Construction Regulation Unit.
- (C) The Applicant has indicated the 6 and 11 April 2016 nights as alternative dates for the above work as a contingency for inclement weather.
- (D) The Applicant must contact the Glebe Police to obtain a separate police permit and to discuss deployment of user pay police for the road closure.
- (E) The Applicant is to obtain a Road Occupancy Licence from the Transport Management Centre prior to commencement of works.
- (F) If the above closure dates conflict with any Light Rail works, other major works or special events, they may be changed to new dates in consultation with the Transport Management Centre and the Glebe Police.
- (G) The Applicant must provide a telephone number of the supervisor responsible for the proposed closure and include contact details in the notification letters to be distributed to affected stakeholders.

VOTING MEMBERS FOR THIS ITEM

<i>Voting Members</i>	<i>Support</i>	<i>Object</i>
City of Sydney		
Roads and Maritime Services		
NSW Police – Leichhardt LAC		
Representative for the Member for Balmain		

DECISION

BACKGROUND

Retro Traffic has applied for the temporary road closure of Francis Street, between Glebe Point Road and Bay Street, Glebe, on Monday 4 April 2016 and Tuesday 5 April 2016 from 9pm to 5am.

COMMENTS

The proposed temporary road closure is required to allow a mobile crane to be used to delivery escalators to Broadway Shopping Centre.

The Applicant has been engaged by the Broadway Shopping Centre management to undertake these works.

The Applicant has provided a site-specific Traffic Control Plan that includes details of barricades, signs, flagmen and other traffic devices to implement the proposed road closure.

The temporary road closure will not affect any other properties, as local access will be provided at all times and alternative access routes are available nearby.

CONSULTATION

The Applicant will be required to notify affected stakeholders as stipulated in Schedule C.

FINANCIAL

All costs associated with the proposed closure will be borne by the Applicant.

ATTACHMENTS

Mobile Crane – Temporary Road Closures – Francis Street Glebe

Ajay Nayyar, Traffic Works Coordinator

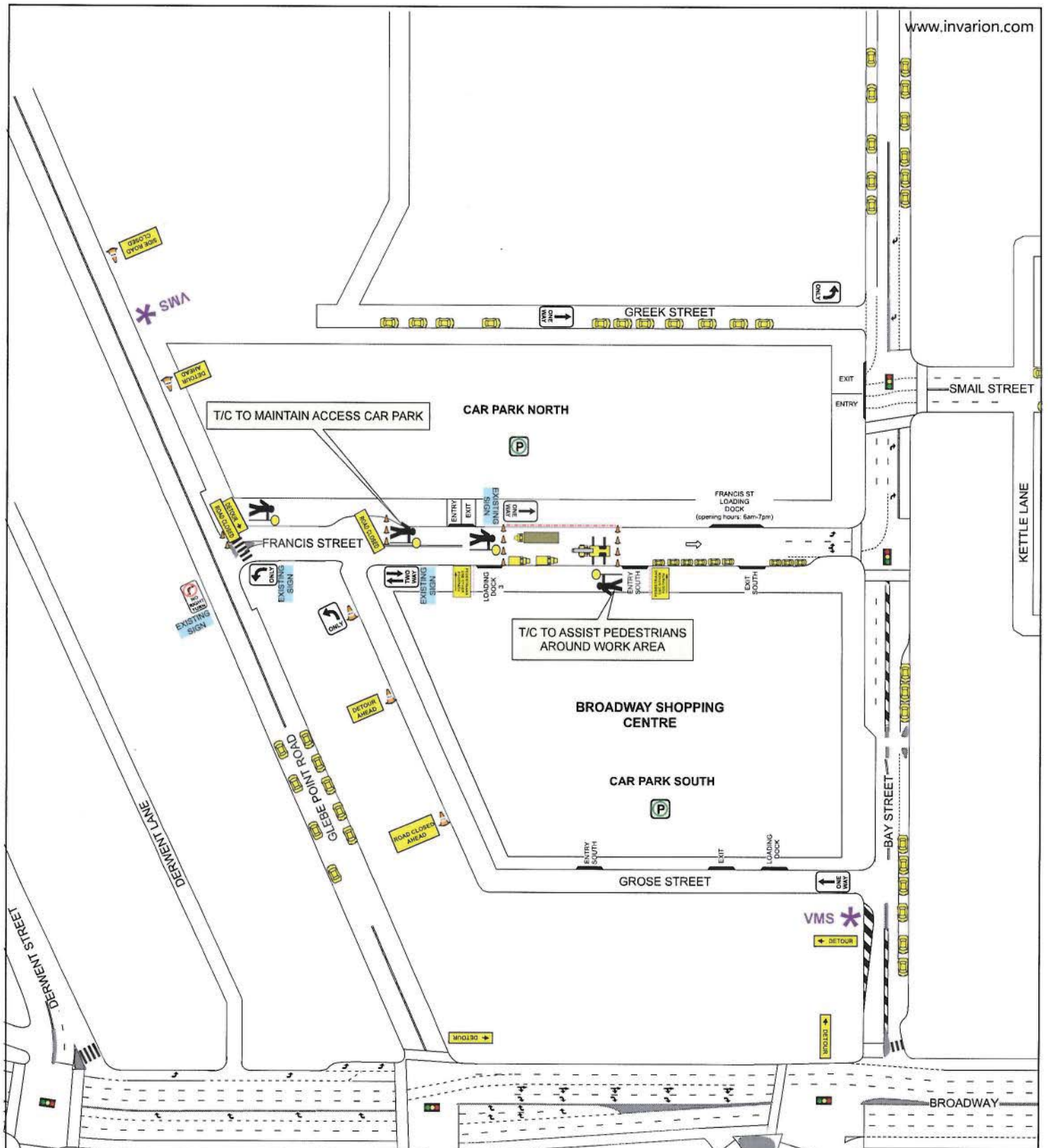

NOTE:

- ACCESS MAINTAINED TO CAR PARK NORTH & LOADING DOCK AT ALL TIMES
- TRUCKS TO ENTER AND EXIT VIA GLEBE POINT ROAD (LEFT TURN IN AND LEFT TURN OUT)

 <p>Designed by: <i>[Signature]</i> Design & Inspect Ticket No: 2273016584 Checked by: <i>[Signature]</i> Design & Inspect Ticket No: 2253014469</p>	<p>Date: 05/02/2016 Author: Retro Traffic Project: Johnstons Transport Drawn By: Sarah Cooney Licence No: 2273016584 TCP No: RT-JT-0564 UBD Ref: 12 M 16</p> <p>Comments: Location: Francis Street in Glebe Task: Delivery & Installation of Escalators to Shopping Centre Traffic Control Required: Road Closure - Detour; Pedestrian Management</p> <p>Note: All sign spacing & taper lengths are in accordance with Australian Standards AS1742.03 and RMS TCWS Manual 4.0. Distances between signs may vary due to on site constraints e.g. parked vehicles/vegetation. Plan is not to scale.</p>	<p align="center">TRAFFIC CONTROL PLAN ON SITE MODIFICATION</p> <p>Modified By:</p> <p>Select & Modify Red Ticket No:</p> <p>Date: Time:</p> <p>Signature:</p>
---	---	---

